

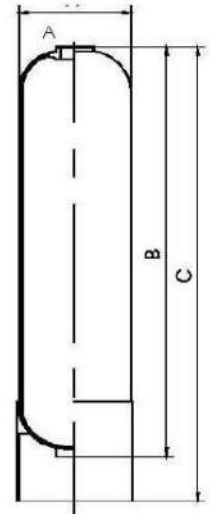

- Liner wall thickness available from 0.150" (3.8mm) up to 0.300" (7.6mm) corresponding to the vessel diameter
- Full choice of pressure vessel available up to 72" diameter with 94" height
- Top & Bottom openings available for 18" through 36" tanks
- Maximum Operating Pressure 150 psi (10.5 kgf/cm<sup>2</sup>)
- Maximum Operating Temperature 120F(49°C)

### 6"-16" tanks with PE liner

No.	Size		Liner Material	Opening		A Diameter		B Height Without Base		C Height With Base		Capacity	
	(In)	(mm)		Top	Bottom	(In)	(mm)	(In)	(mm)	(In)	(mm)	Gallons	Liters
1	07×35	170×890	PE	2.5"Threaded	N/A	7	181	35	890	35.6	905	6.2	19.7
2	08×17	200×430	PE	2.5"Threaded	N/A	8	206	17	430	17.6	445	3.1	11.7
3	08×35	200×890	PE	2.5"Threaded	N/A	8	206	35	890	35.6	905	6.6	25
4	09×35	220×890	PE	2.5"Threaded	N/A	9	232	35	890	35.6	905	8.3	31.4
5	10×35	240×890	PE	2.5"Threaded	N/A	10	257	35	890	35.6	905	10.2	38.6
6	10×54	240×1370	PE	2.5"Threaded	N/A	10	257	54.1	1375	54.7	1390	16.4	62
7	12×52	300×1320	PE	2.5"Threaded	N/A	12	308	52	1320	52.8	1340	22.2	84
8	12×52	300×1320	PE	4.5"Threaded (BTRS)	N/A	12	308	52	1320	52.8	1340	22.2	84
9	13×54	330×1370	PE	2.5"Threaded	N/A	13	334	54	1370	54.7	1390	27.5	104
10	14×65	350×1620	PE	2.5"Threaded	N/A	14	360	63.8	1620	64.6	1640	40.6	154
11	14×65	350×1620	PE	4"Threaded	N/A	14	360	63.8	1620	64.6	1640	40.6	154
12	16×65	400×1620	PE	2.5"Threaded	N/A	16	410	63.8	1620	64.6	1640	49	185
13	16×65	400×1620	PE	4"Threaded	N/A	16	410	63.8	1620	64.6	1640	49	185
14	16×65	400×1620	PE	4"Threaded	4"Threaded	16	410	63.8	1620	64.6	1640	49	185



### 1865-4072 with PE Liner, 4872 and above are with FRP liner

No.	Size		Liner Material	Opening		A Diameter		B Height Without Base		C Height With Base		Capacity	
	(In)	(mm)		Top	Bottom	(In)	(mm)	(In)	(mm)	(In)	(mm)	Gallons	Liters
1	18×65	450×1650	PE	4"Threaded	N/A	18.5	470	65.6	1665	74.9	1902	66.8	253
2				4"Threaded	4"Threaded	18.5	470	65.6	1665	74.9	1902	66.8	253
5	20×72	500×1800	PE	4"Threaded	N/A	20.5	520	70.9	1800	80.4	2042	89	337
6				4"Threaded	4"Threaded	20.5	520	70.9	1800	80.4	2042	89	337
6	21×62	530×1600	PE	4"Threaded	N/A	21.7	550	63	1600	72.5	1842	88	333
7				4"Threaded	4"Threaded	21.7	550	63	1600	72.5	1842	88	333
10	24×72	600×1800	PE	4"Threaded	N/A	24.4	620	70.9	1800	80.4	2042	126.8	480
11				4"Threaded	4"Threaded	24.4	620	70.9	1800	80.4	2042	126.8	480
14	30×72	750×1800	PE	4"Threaded	N/A	30.5	775	70.9	1800	80.5	2045	195.5	740
15				4"Threaded	4"Threaded	30.5	775	70.9	1800	80.5	2045	195.5	740
18	36×72	900×1800	PE	4"Threaded	N/A	36.4	925	70.9	1800	84.4	2145	283	1071
19				4"Threaded	4"Threaded	36.4	925	70.9	1800	84.4	2145	283	1071
22	40×72	1000×1800	PE	6" FLG	6" FLG	40.4	1025	70.9	1800	84.6	2148	338.7	1282
23	48×72	1200×1800	FRP	6" FLG	6" FLG	48.2	1225	70.9	1800	82.9	2105	477.7	1808
24	48×86	1200×2150	FRP	6" FLG	6" FLG	48.2	1225	84.69	2150	96.31	2445	538.4	2035

